

2.5C

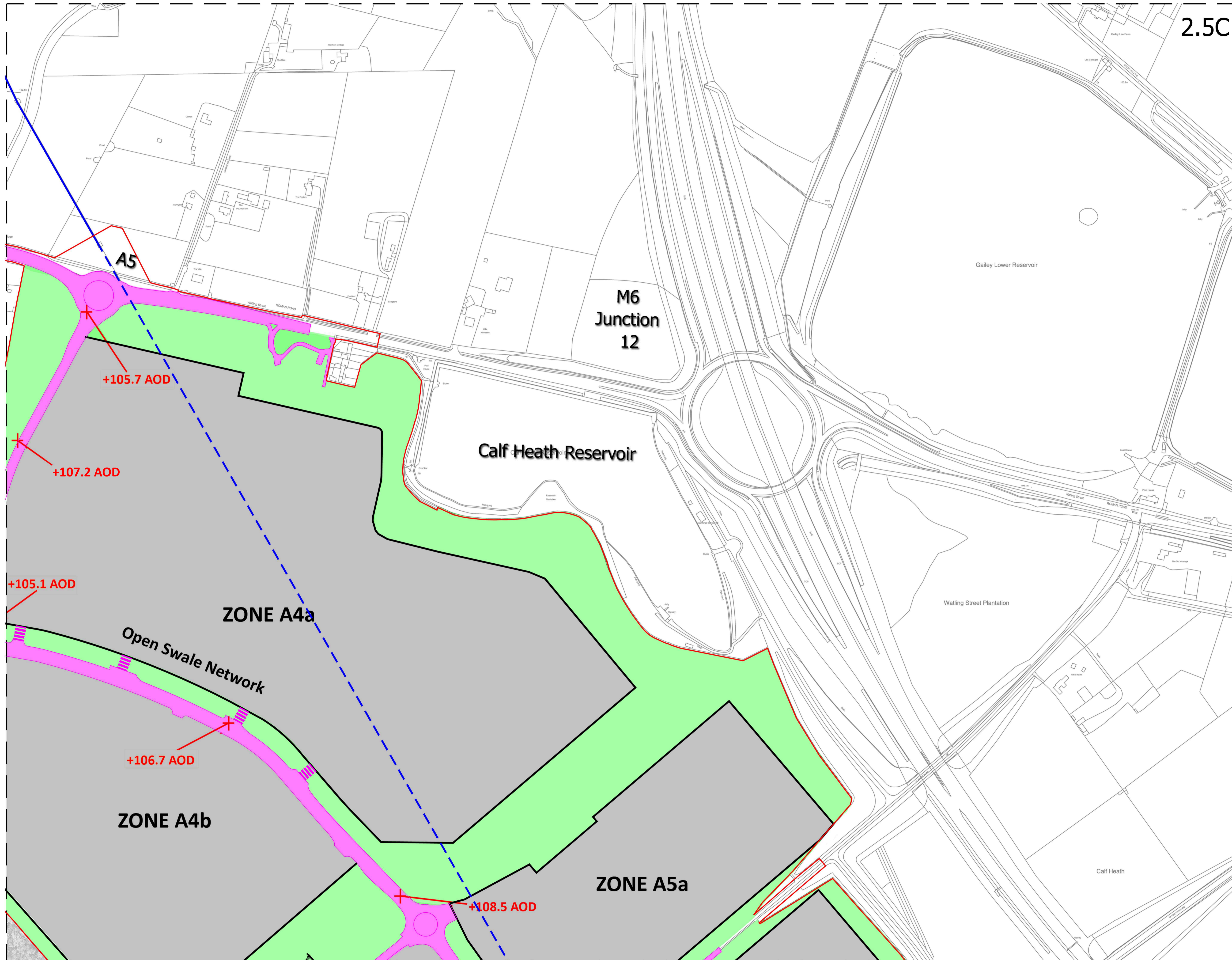
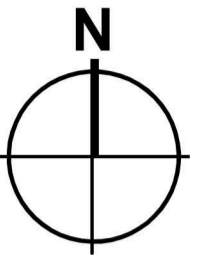

- Order Limits
- Zone A1-A7 - Development Areas
- Zone B - Rail terminal, container storage, Parking area and associated welfare facilities.
- Zone C - Rail corridor including new rail lines and landscaping.
- New on-site road infrastructure and access.
- Landscaping
- Estate Management Offices / Amenity and Welfare Facilities
- Residential Property and Curtilage
- Plot Access Points through Green Infrastructure. (precise location and extent to be approved at time of submission of details for approval post DCO approval)
- Canal crossings to be demolished
- Existing Overhead Electricity Cables
- Existing Overhead Electricity Cables to be re-routed underground

Limits of Deviation shown on works plan and set out in Article 4 of the DCO

Note:
All AOD levels shown for the new on-site road infrastructure are subject to a vertical deviation of 0.5 metres upwards or downwards

West Midlands Interchange			
Project THE WEST MIDLANDS RAIL FREIGHT INTERCHANGE ORDER 2020			
Drawing Status SUBMISSION			
Drawing Title PARAMETER PLAN		Drawing Size A1	
DEVELOPMENT ZONE PLAN - SHEET 3			
Regulation 5 (2) (o)		Document 2.5C	
Drawn SM	Date MARCH 2018	Scale 1/2500	Reviewed PMJS
Drawing No. 4990 - 02003			Rev. 12